

Giotto Numberlight LED



IS1455

3032813 3032814
3032839 3032840
3032861 3032862

Disconnect from mains supply before replacing the fuse or the lamp.
Vor dem Einsetzen der Sicherung oder der Lampe Spannungsfreiheit herstellen.
Débrancher le secteur avant de remplacer le fusible ou l'ampoule.
Desconectar del suministro de la red, antes de realizar la sustitución del fusible o de la lámpara.
Voor het vervangen van lamp of zekering, eerst netspanning uitschakelen.
Koppla bort spänningen före byte av en säkring eller en lampa.

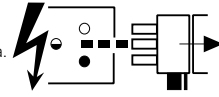

Switch Off
Abschalten
Débrancher
Desconectar
Uitschakelen
Stäng av

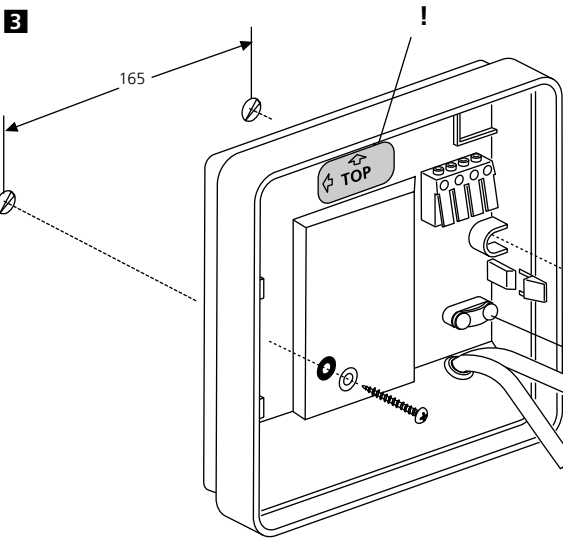
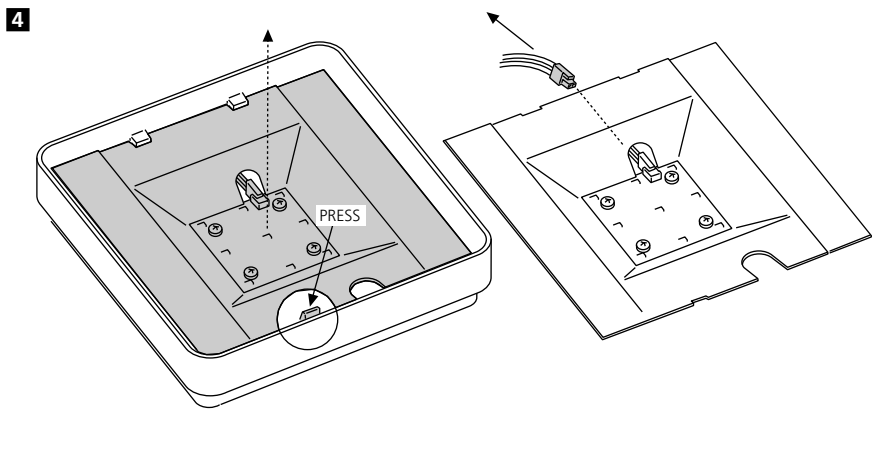
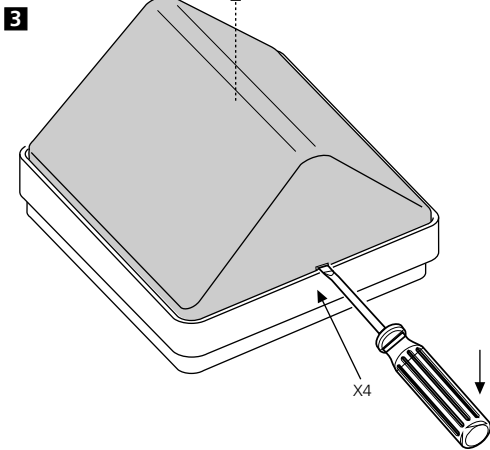

STD
230-240V~
2 x 0.75mm² Min. P/L, N.
DIM/DALI
230-240V~
2 x 0.75mm² Min. P/L, N
+
2 x 0.75mm² Min. +,-.

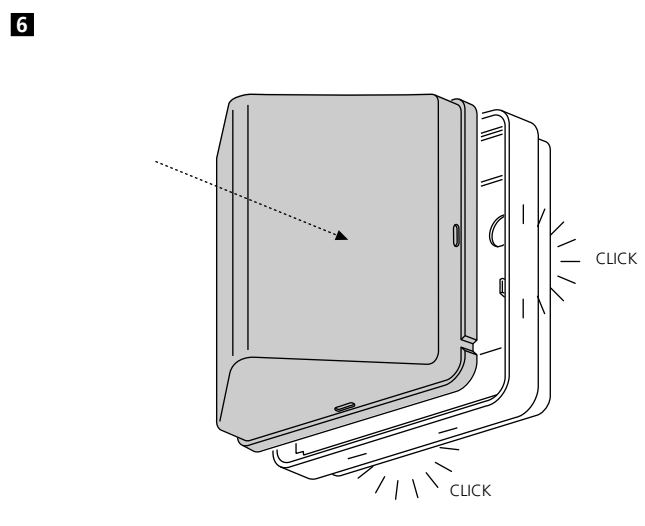
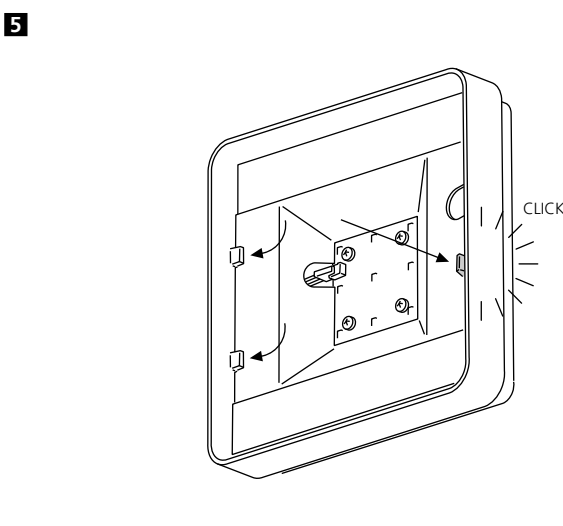
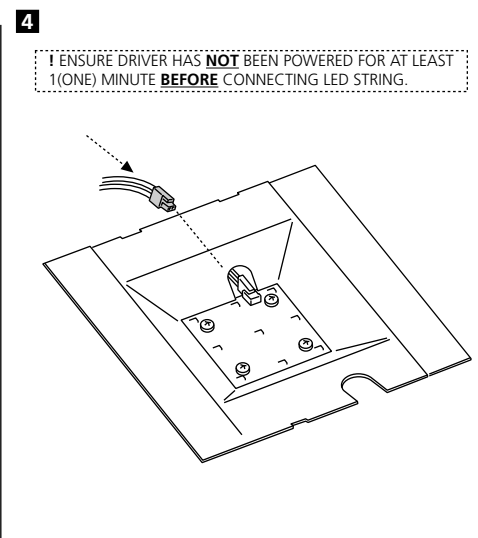
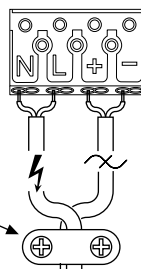

Suitable for use indoors
Geeignet für Innenanwendung
Pour un usage interne
Adecuada para uso en interiores
Geschikt voor gebruik binnen
Lämplig för inomhusbruk

